



# Construction to Move from East to West Side of US 70 North Main Street on August 22

***On August 22, 2024, crews are scheduled to move construction from the east side of US 70 North Main Street to the west side of the roadway between Spitz Ave/North Solano Drive and Elks Drive/N. Triviz Drive.***

During this phase of construction, scheduled to last through fall 2024, the following traffic impacts will be in place:

- The Alameda Arroyo trail crossing will remain **CLOSED**.
- Westbound US 70/North Main Street will have one lane open from Elks Drive to south of the Alameda Arroyo Bridge, then two lanes open to Spitz Ave.
- Eastbound US 70/North Main Street will have two lanes open from N. Solano Drive to N. Triviz Drive.

**Access will be maintained to all businesses and residences during construction.**

**The speed limit will be 35 miles per hour throughout the construction zone. Motorists are encouraged to use extra caution in the construction zone, obey lower posted speed limits and allow extra time to reach their destinations.**

**Regular work hours will be Monday–Friday 7 a.m.–5 p.m.,** although the contractor may work longer hours or on weekends if needed. Additional phases will follow, with the project expected to be completed in fall/winter 2024.

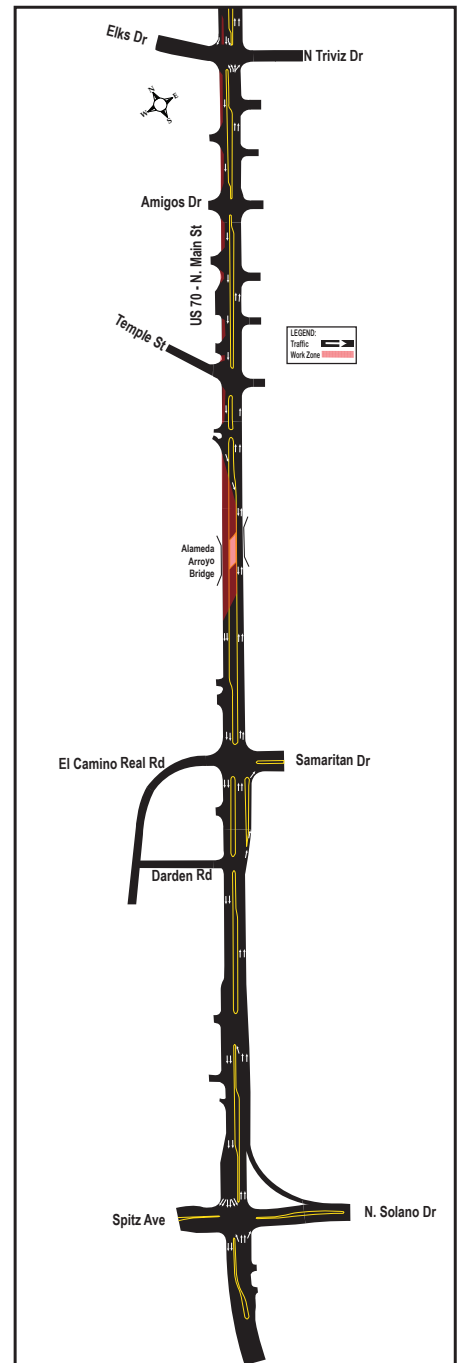

**STAY IN THE LOOP!** Get info or sign up for free construction updates at [www.us70mainstreet.com](http://www.us70mainstreet.com) or get info at [www.nmroads.com](http://www.nmroads.com)