



# Roadway Improvements to US 70 North Main Street

CN LC00271

March 21, 2024



## Construction Team

**Aaron Chavarria**, District Engineer, NMDOT

**Earl Franks**, Construction Engineer, NMDOT

**Ryan Tafoya**, Project Manager, NMDOT

**Fidencio Villalobos**, President, El Terrero Construction

**Matt Villalobos**, Vice President/Project Manager, El Terrero Construction



## Communications Team

**Ami Evans**, Public Information Officer, District 1, NMDOT

575-640-5981

[ami.evans@dot.nm.gov](mailto:ami.evans@dot.nm.gov)

**Patti Watson**, Communications Contractor, CWA Strategic Communications

505-245-3134 office • 505-269-9691 cell • 1-800-687-3417 toll-free

[pattiw@cwastrategic.com](mailto:pattiw@cwastrategic.com)

**Hal Roberts**, Communications Contractor, CWA Strategic Communications

505-245-3138 office • 505-417-9989 cell

[halr@cwastrategic.com](mailto:halr@cwastrategic.com)



## Project Purpose

The area of US 70 North Main Street being improved was initially built in its current configuration (4 lanes divided) in the late 1950s.



Public meetings and meetings with businesses were held in 2016 and 2017 to solicit public feedback on design alternatives and proposed improvements. This project is designed to:

- 1) Replace an **obsolete bridge**
- 2) Facilitate **better traffic flow**
- 3) Improve **traffic safety**



## Construction



- Construction began on January 30, 2024 and is expected to last through **October 2024**
- The project is currently being built in three (3) combined phases
- Currently, construction is in **Phase 1 & 3-A**
- All construction is weather permitting and is subject to change without notice
- Regular work hours are **Monday-Friday, 7 a.m. to 5:30 p.m.** although the contractor may work longer hours or on weekends if needed



## Progress to Date

- Eastbound US 70 North Main Street has been widened from Samaritan Drive to the bridge over the Alameda Arroyo
- New curb and gutter has been installed in this section of the roadway
- Temporary traffic signal has been installed at intersection of US 70/North Main and Elks/N. Triviz





## Work Remaining in Phase 1 & 3-A

The week of March 25-29, 2024, crews will begin working on the driveways linking businesses on the east side to US 70 North Main

- Where businesses only have one driveway access, crews will work on half of the driveway at a time
- If businesses have access through two driveways, crews will work on one driveway, then move to the other
- Construction of each driveway will last about 3-5 days
- Access into and out of businesses will remain open

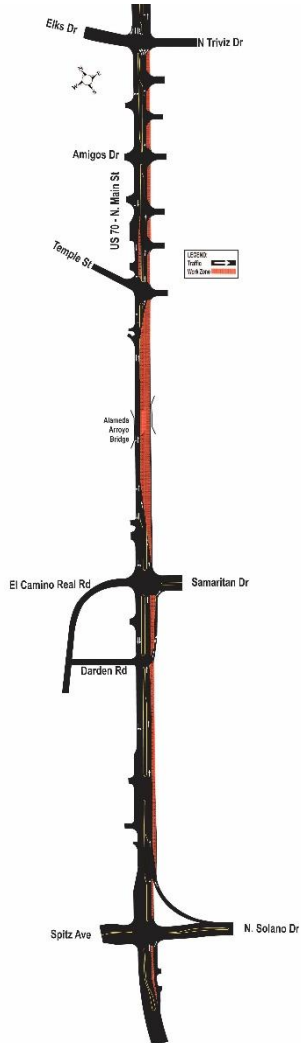



## Work Remaining in Phase 1 & 3-A (continued)

- Crews will also continue reconstructing the east side of the roadway north and south of the Alameda Arroyo bridge
- Additional sidewalk, curb and gutter will be installed
- The entire eastbound section of the project will be milled and resurfaced

**This phase is estimated to last through June 2024**

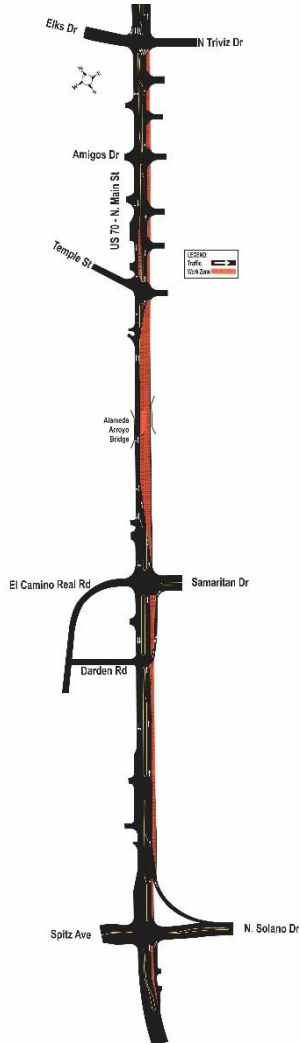





## Continuing Traffic Impacts

- Eastbound US 70 North Main will be **restricted to one lane** from North Solano Drive to North Triviz Drive
- The Alameda Arroyo Trail Crossing **will remain closed**
- The speed limit in the area is **35 miles per hour**
- Motorists should **expect delays** and **allow extra time when traveling**
- Motorists should **use caution** and **look out for equipment and workers**

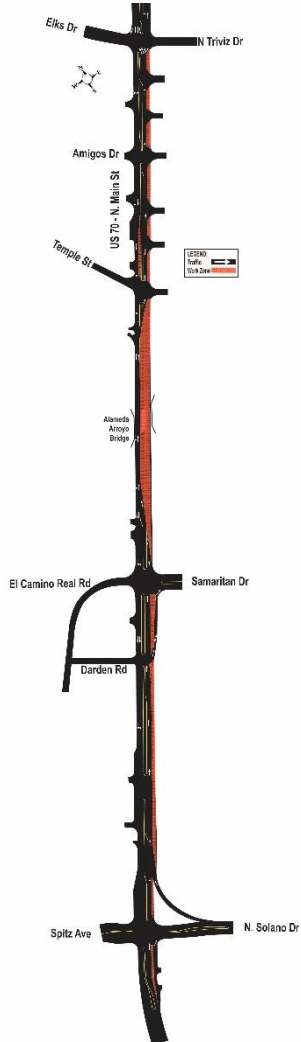





## Phase 2 (Combined with Phases 4-A & 4-B) *continued*

### Build Westbound Alameda Arroyo Box Culvert Embankment; Storm Drainage and Manholes

- Install a storm drain crossing protected by temporary wall barrier
- Mill rest of westbound area for resurfacing to end of project
- Widen westbound roadway
- Build US 70 westbound lanes, sidewalk and outside curb and gutter



**Estimated Duration of Phase 2: 17 Weeks (4 months, 1 week)**



## Phase 3 (Combined with Phase 5)

### Build Storm Drain, Manholes and Alameda Arroyo Box Culvert Medians as well as Crossover Locations

- **Alameda Trail Crossing reopens**
- Build storm drain and manholes and new median when storm drain is complete
- Build new median and remainder of medians
- Install storm drainage crossing



**Estimated Duration of Phase 3: 6 Weeks (1.5 months)**



## Phase 3 (Combined with Phase 5) continued

### Build Storm Drain, Manholes and Alameda Arroyo Box Culvert Medians as well as Crossover Locations

- **Both eastbound and westbound traffic on US 70 will have left lanes closed** with two lanes open
- Remove temporary detour pavement near Alameda Arroyo crossing and other crossovers

**Estimated Duration of Phase 3: 6 Weeks (1.5 months)**



## Traffic Impacts

- Due to lane closures, motorists should seek an alternate route and/or allow themselves extra time to reach their destination
- Access will be maintained to all residents and businesses
- Construction updates will be issued on a regular basis; to sign up, visit:
  - [www.US70MainStreet.com](http://www.US70MainStreet.com)
  - Information will also be available at [www.nmroads.com](http://www.nmroads.com)





## **Contacts for Concerns or Questions During Construction:**

**Patti Watson**

**505-245-3134 office • 505-269-9691 cell • 1-800-687-3417 toll-free**  
**pattiw@cwastrategic.com**

**Hal Roberts**

**505-245-3138 office • 505-417-9989 cell**  
**halr@cwastrategic.com**

Or you can email the project website:  
**[www.us70mainstreet.com](http://www.us70mainstreet.com)**





# QUESTIONS?





**THANK YOU!**